

PARTS FOR CARRIAGE UPPER PART Fig. A

# PARTS FOR CARRIAGE UPPER PART

| no. | Description                        | Revised | Q'ty | Ref. No. | Parts No. | Description                               | Revised | Q'ty |
|-----|------------------------------------|---------|------|----------|-----------|---|---------|------|
|     | K carriage complete set for KH930  |         | 1    | AI-67    | 409599003 | Stitch dial                               |         | 1    |
| 001 | Carriage plate                     |         | 1    | 68       | 414174001 | Stitch dial indicator plate               |         | 1    |
| 001 | Stitch cam guide plate             |         | 2    | 69       | 406283001 | Stitch dial presser                       |         | 1    |
| 046 | Snap ring 3                        |         | 2    | 70       | 060660606 | Screw 3.18 - 40 x 6                       |         | 1    |
| 001 | Raising cam change spring          |         | 1    | 71       | 409601005 | Stitch dial cap                           |         | 1    |
| 000 | Change plate A                     |         | 1    | 72a-b    |           | K carriage cover assembly                 |         | 1    |
| 000 | Change plate B                     |         | 1    | 72b      | 414111001 | Carriage cover decoration plate for KH930 |         | 1    |
| 001 | Change plate A spring              |         | 1    | 72c      | 037351615 | Screw 3.5 x 16                            |         | 2    |
| 001 | Change plate B spring              |         | 1    | 73       | 409605007 | K carriage handle (White)                 |         | 1    |
| 001 | Change plate spring                |         | 1    |          | 409605009 | K carriage handle (Beige and White)       |         | 1    |
| 001 | Collar                             |         | 1    | 74       | 409608001 | Screw                                     |         | 1    |
| 001 | Change plate guide collar          |         | 1    | 75       | 413437001 | Plain lever knob (White)                  |         | 1    |
| 001 | MC cam Change spring               |         | 2    |          | 413437003 | Plain lever knob (Beige)                  |         | 1    |
| 001 | MC cam spring A                    |         | 2    | 76       | 414112001 | H.C.L knob (White)                        |         | 1    |
| 001 | Front slide plate spring           |         | 1    |          | 414112002 | H.C.L knob (Beige)                        |         | 1    |
| 006 | + - Screw 3.18 - 40 x 4            |         | 1    |          |           |   |         |      |
| 001 | Tuck cam spring                    |         | 1    |          |           |   |         |      |
| 001 | Presser ring                       |         | 1    |          |           |   |         |      |
| 001 | Handle lock spring                 |         | 2    |          |           |   |         |      |
| 006 | Screw 3.57 - 40 x 4                |         | 1    |          |           |   |         |      |
| 001 | Intarsia lever, R                  |         | 1    |          |           |   |         |      |
| 001 | Intarsia lever, L                  |         | 1    |          |           |   |         |      |
| 001 | Intarsia lever collar              |         | 1    |          |           |   |         |      |
| 006 | Screw 3.18 - 40 x 4                |         | 1    |          |           |   |         |      |
| 001 | Intarsia lever spring              |         | 1    |          |           |   |         |      |
| 001 | Intarsia cam A, R                  |         | 1    |          |           |   |         |      |
| 001 | Intarsia cam A, L                  |         | 1    |          |           |   |         |      |
| 001 | Nut                                |         | 2    |          |           |   |         |      |
| 001 | Intarsia cam A spring              |         | 1    |          |           |   |         |      |
| 001 | Rear plate                         |         | 1    |          |           |   |         |      |
| 001 | Row counter tripper                |         | 1    |          |           |   |         |      |
| 001 | Knit leader tripper                |         | 1    |          |           |   |         |      |
| 006 | Screw 3.18 - 40 x 4                |         | 4    |          |           |   |         |      |
| 003 | K carriage sensor magnet assembly  |         | 1    |          |           |   |         |      |
| 001 | Shift spring for K carriage sensor |         | 1    |          |           |   |         |      |
| 335 | Washer                             |         | 1    |          |           |   |         |      |
| 001 | Shaft for K carriage sensor magnet |         | 1    |          |           |   |         |      |
| 001 | End needle selection cam spring    |         | 1    |          |           |   |         |      |
| 001 | Needle selection change spring, R  |         | 1    |          |           |   |         |      |
| 001 | Needle selection change spring, L  |         | 1    |          |           |   |         |      |
| 001 | Connecting plate spring, R         |         | 1    |          |           |   |         |      |
| 001 | Connecting plate spring, L         |         | 1    |          |           |   |         |      |
| 001 | Upper slide plate                  |         | 1    |          |           |   |         |      |
| 346 | Snap ring                          |         | 2    |          |           |   |         |      |
| 001 | Cam button unit                    |         | 1    |          |           |   |         |      |
| 006 | Screw 3.18 - 40 x 4                |         | 1    |          |           |   |         |      |
| 006 | Screw 3.57 - 40 x 4                |         | 1    |          |           |   |         |      |
| 003 | Thumb nut                          |         | 1    |          |           |   |         |      |
| 006 | Change knob                        |         | 1    |          |           |   |         |      |

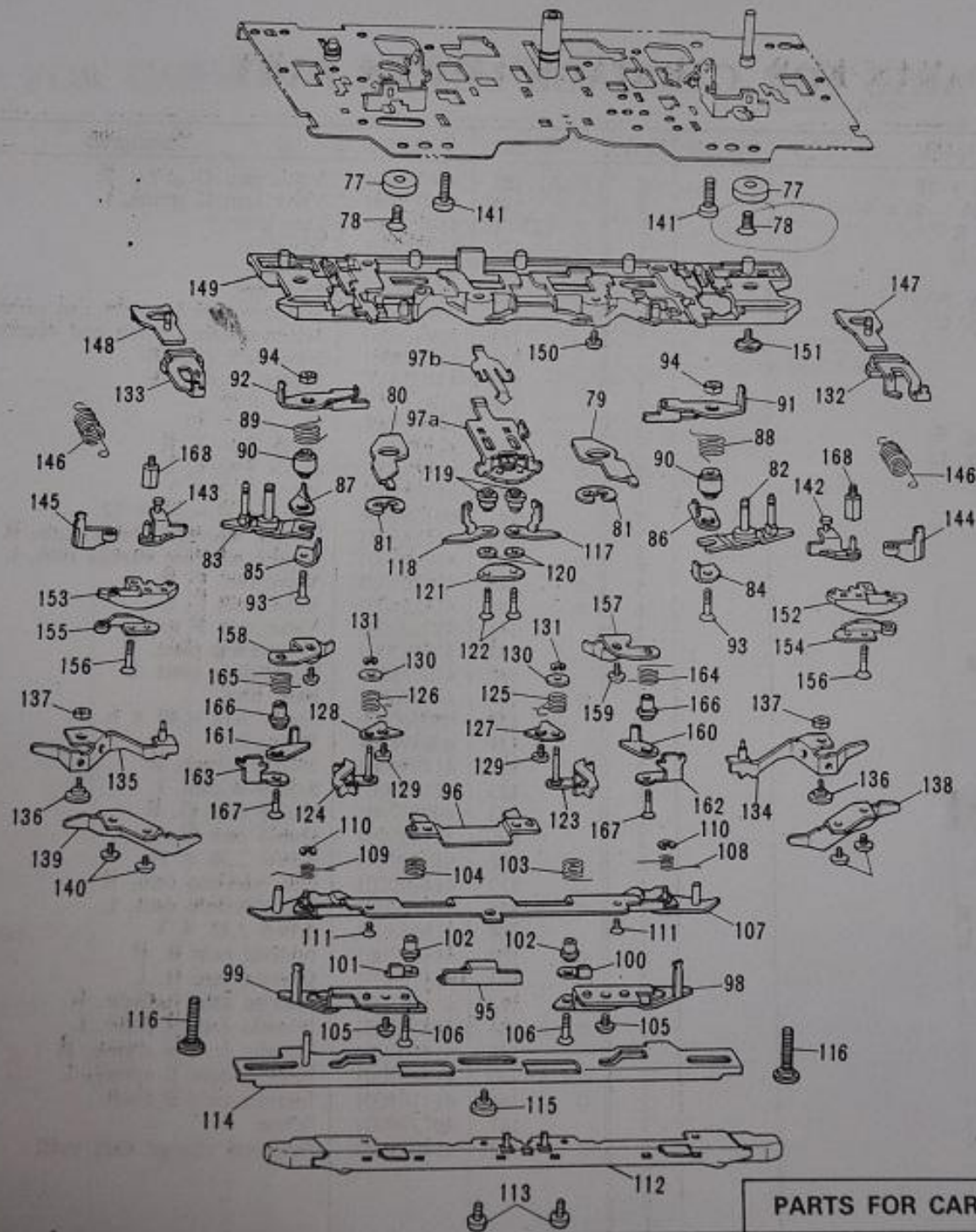



PARTS FOR CARRIAGE LOWER PART Fig. 1

| No.  | Description                   | Revised | Q'ty | Ref. No.  | Parts No.     | Description                        | Revised | Q'ty |
|------|-------------------------------|---------|------|-----------|---------------|------------------------------------|---------|------|
| 5000 | Carriage magnet 16 x 18       |         | 2    | o A11-125 | 414075001     | Valve cam G spring, R              |         | 1    |
| 3006 | Flat head screw 3.18 - 40 x 9 |         | 2    | o 126     | 414076001     | Valve cam G spring, L              |         | 1    |
| 2001 | Raising cam guide, R          |         | 1    | o 127/128 | 414077001     | Cam plate                          |         | 1    |
| 3001 | Raising cam guide, L          |         | 1    | o 129     | 414049001     | Screw                              |         | 2    |
| 0346 | Snap ring                     |         | 2    |           | 130 025350233 | Washer                             |         | 2    |
| 6001 | Stitch cam assembly, R        |         | 1    |           | 131 048020346 | Snap ring                          |         | 2    |
| 0001 | Stitch cam assembly, L        |         | 1    |           | 132 409510001 | Selection cam for right end needle |         | 1    |
| 6001 | Sub stitch cam, R             |         | 1    |           | 133 409513001 | Selection cam for left end needle  |         | 1    |
| 7001 | Sub stitch cam, L             |         | 1    | o 134     | 414078001     | Separation cam, R                  |         | 1    |
| 8001 | Valve cam D, R                |         | 1    | o 135     | 414080001     | Separation cam, L                  |         | 1    |
| 9001 | Valve cam D, L                |         | 1    |           | 136 410115001 | Screw 3.18                         |         | 2    |
| 0001 | Valve cam D spring, R         |         | 1    |           | 137 021660306 | Nut 3.18 - 40                      |         | 2    |
| 1001 | Valve cam D spring, L         |         | 1    | o 138     | 414082001     | Guide cam F, R                     |         | 1    |
| 5001 | Sub stitch cam shaft          |         | 2    | o 139     | 414083001     | Guide cam F, L                     |         | 1    |
| 2001 | MC cam, R                     |         | 1    |           | 140 413554001 | Screw 3.18 x 3                     |         | 4    |
| 3001 | MC cam, L                     |         | 1    |           | 141 062681206 | Screw 4.37 - 40 x 12               |         | 2    |
| 2001 | Screw                         |         | 2    | o 142     | 414185001     | Needle selection change cam, R     |         | 1    |
| 0306 | Nut                           |         | 2    | o 143     | 414187001     | Needle selection change cam, L     |         | 1    |
| 4001 | Slide cam                     |         | 1    | o 144     | 414203001     | Valve cam F, R                     |         | 1    |
| 5001 | Slide cam guide               |         | 1    | o 145     | 414204001     | Valve cam F, L                     |         | 1    |
| 6001 | Guide cam C                   |         | 1    |           | 146 410129001 | Valve cam F spring                 |         | 2    |
| 2000 | Guide cam C spring            |         | 1    |           | 147 410123001 | Connecting plate, R                |         | 1    |
| 1001 | Guide cam B, R                |         | 1    |           | 148 410125001 | Connecting plate, L                |         | 1    |
| 5001 | Guide cam B, L                |         | 1    | o 149     | 414086001     | Rear foot                          |         | 1    |
| 6001 | Valve cam B, R                |         | 1    |           | 150 060660406 | Screw 3.18 - 40 x 6                |         | 4    |
| 7001 | Valve cam B, L                |         | 1    |           | 151 409494001 | Screw 3.57                         |         | 2    |
| 0001 | Valve cam B shaft             |         | 2    | o 152     | 414096001     | Selection cam, R                   |         | 1    |
| 1001 | Valve cam B spring, R         |         | 1    | o 153     | 414098001     | Selection cam, L                   |         | 1    |
| 2001 | Valve cam B spring, L         |         | 1    |           | 154 409537001 | Guide cam G, R                     |         | 1    |
| 4001 | Screw 3.18 x 3                |         | 2    |           | 155 409538001 | Guide cam G, L                     |         | 1    |
| 9001 | Screw                         |         | 2    |           | 156 410030001 | Screw 2.38 x 14                    |         | 2    |
| 5001 | Guide cam A                   |         | 1    | o 157     | 414100001     | Sub selection cam, R               |         | 1    |
| 4001 | Change cam spring, R          |         | 1    | o 158     | 414101001     | Sub selection cam, L               |         | 1    |
| 5001 | Change cam spring, L          |         | 1    |           | 159 413554001 | Screw 3.18 x 3                     |         | 2    |
| 5346 | Snap ring                     |         | 2    | o 160     | 414102001     | Intarsia cam B, R                  |         | 1    |
| 5001 | Screw 3.18 x 4                |         | 2    | o 161     | 414103001     | Intarsia cam B, L                  |         | 1    |
| 2001 | Front foot                    |         | 1    | o 162     | 414104001     | Intarsia cam B plate, R            |         | 1    |
| 4001 | Screw 3.18 x 3                |         | 2    | o 163     | 414105001     | Intarsia cam B plate, L            |         | 1    |
| 2001 | Front slide plate             |         | 1    | o 164     | 414106001     | Intarsia cam B spring, R           |         | 1    |
| 4001 | Screw 3.18 x 4                |         | 1    | o 165     | 414107001     | Intarsia cam B spring, L           |         | 1    |
| 4001 | Screw 3.18                    |         | 2    | o 166     | 414108001     | Intarsia cam B shaft               |         | 2    |
| 6001 | Tuck cam, R                   |         | 1    |           | 167 407299001 | Screw                              |         | 2    |
| 7001 | Tuck cam, L                   |         | 1    | c 168     | 414091001     | Selection change cam shaft         |         | 2    |
| 8001 | Tuck cam, shaft               |         | 2    |           |               |                                    |         | 2    |
| 9001 | Washer                        |         | 2    |           |               |                                    |         | 2    |
| 0001 | Tuck cam plate                |         | 1    |           |               |                                    |         | 1    |
| 9001 | Screw                         |         | 2    |           |               |                                    |         | 2    |
| 0001 | Valve cam G, R                |         | 1    |           |               |                                    |         | 1    |
| 3001 | Valve cam G, L                |         | 1    |           |               |                                    |         | 1    |



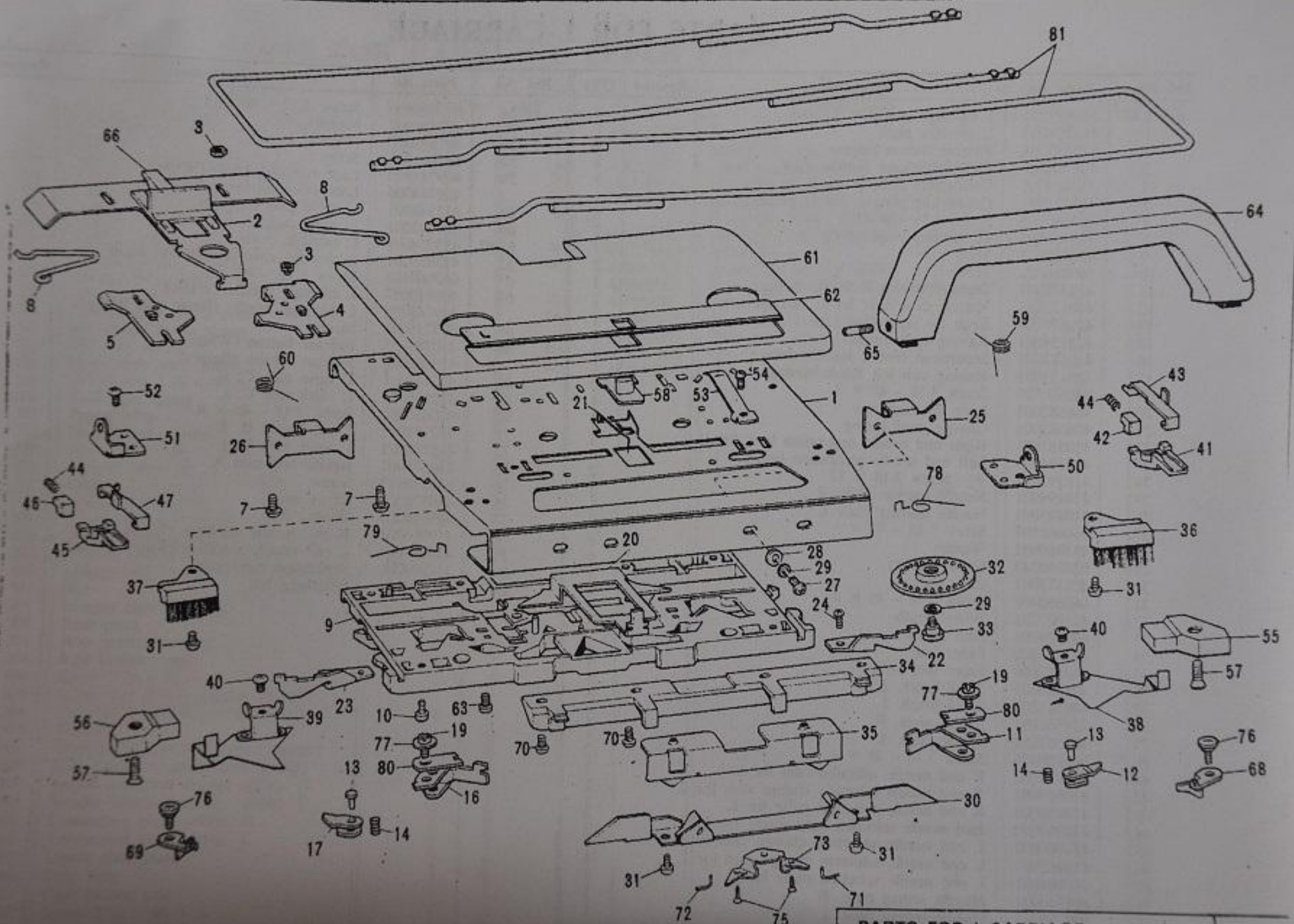

PARTS FOR L-CARRIAGE Fig: F



| Ref. No. | Parts No. | Description                             | Revised | Q'ty | Ref. No. | Parts No. | Description                          | Revised |
|----------|-----------|---|---------|------|----------|-----------|--------------------------------------|---------|
| F- 1-80  | 413953001 | L carriage assembly KH930               |         | 1    | F- 54    | 060660406 | Screw 3.57 - 40 x 4                  |         |
| 1        | 410481001 | L carriage plate                        |         | 1    | 55       | 407454000 | Magnet, R                            |         |
| 2        | 410483001 | Release button plate                    |         | 1    | 56       | 407578000 | Magnet, L                            |         |
| 3        | 408166001 | Stud for release button plate           |         | 4    | 57       | 061661006 | Screw                                |         |
| 4        | 410484001 | Connecting plate R for L carriage       |         | 1    | o 58     | 409744005 | Lace selecting knob (White)          |         |
| 5        | 410485001 | Connecting plate L for L carriage       |         | 1    | o 58     | 409744006 | Lace selecting knob (Beige)          |         |
| 7        | 060660706 | Screw 3.18 - 40 x 7                     |         | 4    | 59       | 412148001 | L valve cam C spring, L              |         |
| 8        | 410486001 | Connecting plate spring                 |         | 2    | 60       | 412147001 | L valve cam C spring, R              |         |
| 9        | 412138001 | Main cam                                |         | 1    | o 61-62  | 413954001 | L carriage cover                     |         |
| 10       | 060660806 | Screw 3.18 - 40 x 8                     |         | 2    | o 62     | 413955001 | L carriage cover decoration plate    |         |
| 11       | 410578001 | Separation cam R for L carriage         |         | 1    | 63       | 060660406 | Screw 3.18 - 40 x 4                  |         |
| 12       | 408132001 | Raising cam right for L carriage        |         | 1    | o 64     | 409948007 | L carriage handle (White)            |         |
| 13       | 410579001 | Shaft for separation cam                |         | 1    | o 64     | 409748008 | L carriage handle (Beige and White)  |         |
| 14       | 408134001 | Raising cam spring                      |         | 1    | 65       | 409751001 | Screw                                |         |
| 16       | 410581001 | Separation cam L for L carriage         |         | 1    | o 66     | 410585005 | Release button (White)               |         |
| 17       | 408137001 | Raising cam left for L carriage         |         | 1    | o 66     | 410585006 | Release button (Beige)               |         |
| 19       | 060660706 | Screw 3.18 - 40 x 7                     |         | 2    | 68       | 412145001 | L valve cam C, R                     |         |
| 20       | 408582001 | Lace selecting cam                      |         | 1    | 69       | 412146001 | L valve cam C, L                     |         |
| 21       | 408583001 | Change lever spring                     |         | 1    | 70       | 060660806 | Screw 3.18 - 40 x 8                  |         |
| 22       | 410583001 | Right end needle separation cam for L   |         | 1    | 71       | 412141001 | L valve cam B, R                     |         |
| 23       | 410584001 | Left end needle separation cam for L    |         | 1    | 72       | 412142001 | L valve cam B, L                     |         |
| 24       | 410592001 | + - Screw 3.18 x 12                     |         | 2    | 73       | 410575001 | Reinforcing cam A                    |         |
| 25       | 410494001 | Needle transfer plate R                 |         | 1    | 75       | 040210812 | Screw 2 x 8                          |         |
| 26       | 410495001 | Needle transfer plate L                 |         | 1    | 76       | 409528001 | Lever shaft                          |         |
| 27       | 060660504 | Screw 3.18 - 40 x 5                     |         | 4    | 77       | 403069001 | Washer 3.3                           |         |
| 28       | 403069001 | Washer                                  |         | 4    | 78       | 410966001 | R end needle selection change spring |         |
| 29       | 028030243 | Spring washer                           |         | 6    | 79       | 410967001 | L end needle selection change spring |         |
| 30       | 408573001 | Cam plate                               |         | 1    | 80       | 412898000 | Separation cam plate                 |         |
| 31       | 060660406 | Screw 3.18 - 40 x 4                     |         | 4    | 81       | 412205001 | Extension rail                       |         |
| 32       | 411003001 | Wheel brush                             |         | 2    |          |           |                                      |         |
| 33       | 405029001 | Stud Screw                              |         | 2    |          |           |                                      |         |
| 34       | 407490000 | Front foot                              |         | 1    |          |           |                                      |         |
| 35       | 408579000 | Front foot holder                       |         | 1    |          |           |                                      |         |
| 36       | 408580003 | Small brush, R                          |         | 1    |          |           |                                      |         |
| 37       | 408581003 | Small brush, L                          |         | 1    |          |           |                                      |         |
| 38       | 408561001 | Spring plate, R                         |         | 1    |          |           |                                      |         |
| 39       | 408562001 | Spring plate, L                         |         | 1    |          |           |                                      |         |
| 40       | 060660406 | Screw 3.18 - 40 x 4                     |         | 2    |          |           |                                      |         |
| 41       | 410957002 | R end needle selection cam for L        |         | 1    |          |           |                                      |         |
| 42       | 410959001 | R end needle selection change cam for L |         | 1    |          |           |                                      |         |
| 43       | 410958001 | R end needle selection plate for L      |         | 1    |          |           |                                      |         |
| 44       | 410963001 | End needle selection cam spring for L   |         | 2    |          |           |                                      |         |
| 45       | 410960002 | L end needle selection change cam for L |         | 1    |          |           |                                      |         |
| 46       | 410962001 | L end needle selection change cam for L |         | 1    |          |           |                                      |         |
| 47       | 410961001 | L end needle selection plate for L      |         | 1    |          |           |                                      |         |
| 50       | 409740001 | Handle setting base, R                  |         | 1    |          |           |                                      |         |
| 51       | 409739001 | Handle setting base, L                  |         | 1    |          |           |                                      |         |
| 52       | 060670506 | Screw 3.57 - 40 x 5                     |         | 2    |          |           |                                      |         |
| 53       | 407522001 | Handle lock spring                      |         | 2    |          |           |                                      |         |

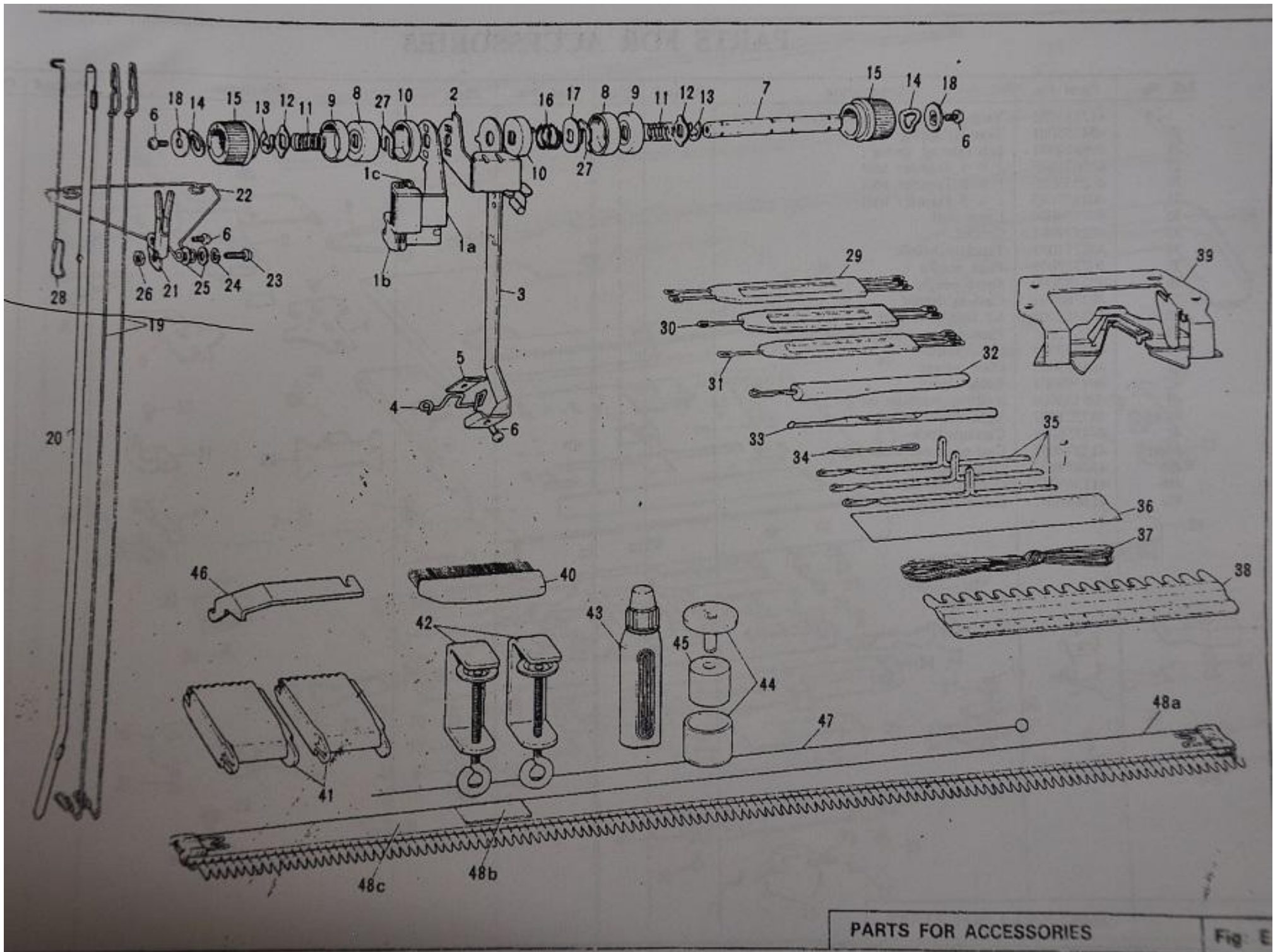

PARTS FOR ACCESSORIES

Fig. E



# PARTS FOR ACCESSORIES

| Ref. No. | Parts No. | Description                  | Revised | Q'ty | Ref. No. | Parts No. | Description |
|----------|-----------|------------------------------|---------|------|----------|-----------|-------------|
| 1-28     | 412183001 | Yarn tension unit assembly   |         | 1    |          |           |             |
| 70       | 404755001 | Take-up spring               |         | 2    |          |           |             |
| 72       | 408614001 | Sub take-up spring           |         | 1    |          |           |             |
| 73       | 402631005 | 2 x 3 Transfer tool          |         | 1    |          |           |             |
| 74       | 402576005 | 1 x 2 Transfer tool          |         | 1    |          |           |             |
| 75       | 402575005 | 1 x 3 Transfer tool          |         | 1    |          |           |             |
| 76       | 407458004 | Latch tool                   |         | 1    |          |           |             |
| 77       | 402577001 | Crochet                      |         | 1    |          |           |             |
| 78       | 402714001 | Tapestry needle              |         | 1    |          |           |             |
| 79       | 407113001 | Plain needle                 |         | 3    |          |           |             |
| 80       | 407483000 | Spare needle case            |         | 1    |          |           |             |
| 81       | 402389001 | Cast-on thread               |         | 1    |          |           |             |
| 82       | 407482004 | 1/1 Needle pusher            |         | 1    |          |           |             |
| 83       | 410971001 | Plating yarn feeder assembly |         | 1    |          |           |             |
| 84       | 403552004 | Hand brush                   |         | 1    |          |           |             |
| 85       | 404883007 | Claw weight                  |         | 2    |          |           |             |
| 86       | 409198001 | Table clamp                  |         | 2    |          |           |             |
| 87       | 405135004 | Knitting machine oil         |         | 1    |          |           |             |
| 44-45    | 487221001 | Yarn wax with case           |         | 1    |          |           |             |
| 46       | 409756001 | Carriage lock                |         | 1    |          |           |             |
| 48a      | 412878001 | Cast-on comb assembly        |         | 1    |          |           |             |
| 48b      | 412879001 | Cast-on comb, long           |         | 1    |          |           |             |
| 48c      | 411365000 | Connecting plate             |         | 1    |          |           |             |
| 48d      | 412881001 | Cast-on comb, short          |         | 1    |          |           |             |



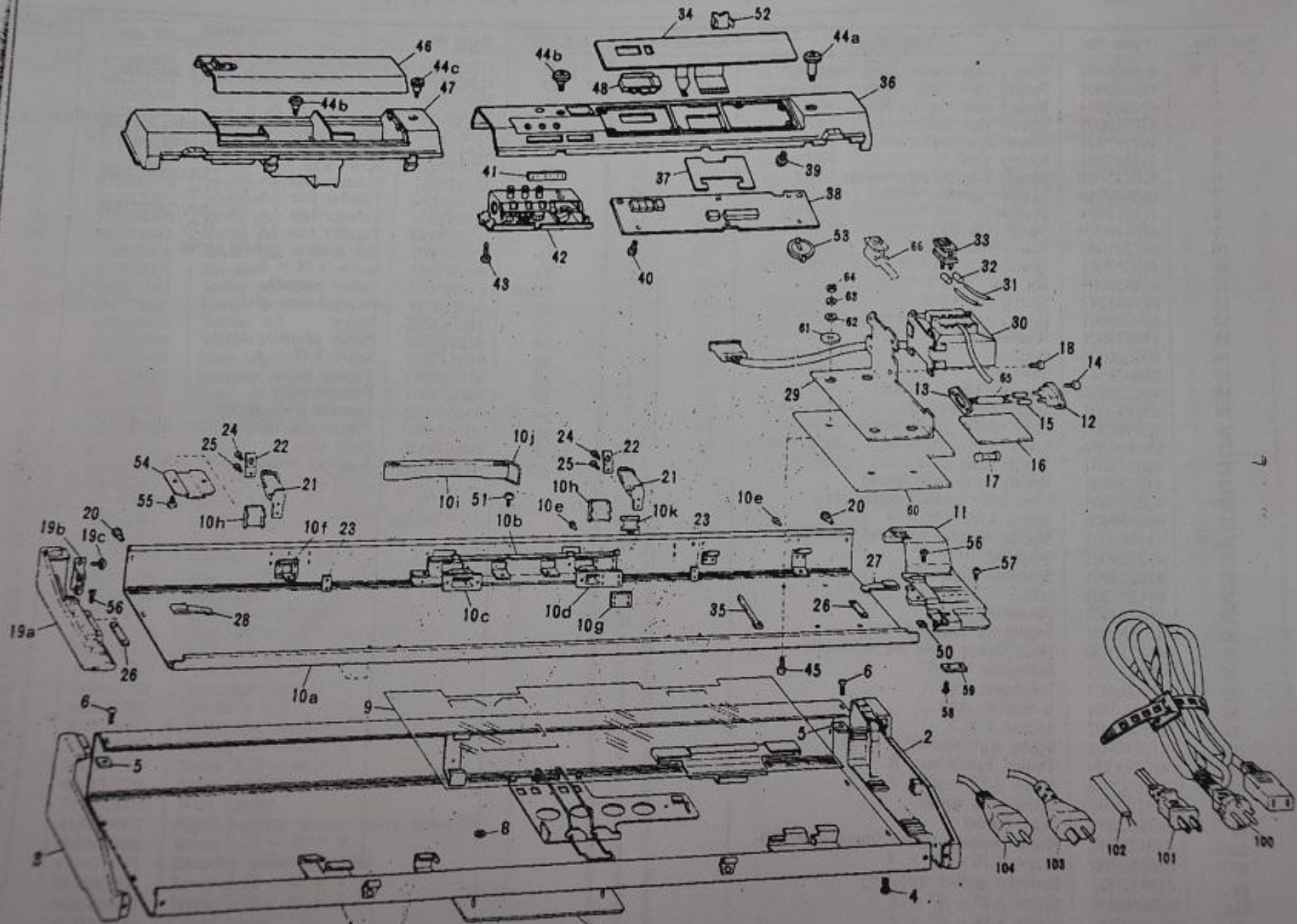

PARTS FOR CARRYING CASE

Fig. D



# PARTS FOR CARRYING CASE

| Ref. No.  | Parts No. | Description                                     | Revised | Q'ty | Ref. No. | Parts No. | Description                                      | Revised | Q'ty |
|-----------|-----------|---|---------|------|----------|-----------|--|---------|------|
| D- 1-9    |           | Carrying case complete KH930                    |         | 1    | D- 35    | 547262001 | Wire binder                                      |         | 2    |
| 1         | 412885002 | Carrying case upper assembly KH930              |         | 1    | o 36     |           | Pattern case                                     |         | 1    |
| 2         | 409692003 | Carrying case upper body                        |         | 1    | o 37     | 414351000 | Cord protection sheet                            |         | 1    |
| 3         | 409693003 | Upper side plate, R                             |         | 1    | o 38     | 413974001 | Main P.C. board assembly                         |         | 1    |
| 4         | 408194003 | Upper side plate, L                             |         | 1    | 39       | 412048006 | Screw 3.18 - 40 x 3                              |         | 6    |
| 5         | 407252001 | Plastic rivet                                   |         | 8    | 40       | 037280816 | Screw 2.6 x 8                                    |         | 6    |
| 6         | 412360001 | Square bat 3.18                                 |         | 2    | 41       | 409721003 | Row counter panel                                |         | 1    |
| 7         | 413956001 | Screw 3.18 x 6                                  |         | 2    | 42       | 410531003 | Row counter assembly                             |         | 1    |
| 8         | 408784001 | Brother name plate 930                          |         | 1    | 43       | 037351016 | Screw 3.5 x 10                                   |         | 2    |
| 9         | 412859001 | Pushing nut                                     |         | 2    | 44a      | 413946001 | Screw 3.18                                       |         | 1    |
|           |           | Packing instruction sheet                       |         | 1    | 44b      | 410535001 | Screw 3.18                                       |         | 2    |
|           |           | Carrying case lower assembly                    |         | 1    | 44c      | 410529001 | Screw 3.18                                       |         | 1    |
| 10a-k     | 413935001 | Carrying case lower body                        |         | 1    | 45       | 410864001 | Screw 3.18 x 14 for Heat sinker (220V/230V/240V) |         | 4    |
| 17.65b.66 | 413938001 | Lower side plate R, assembly for 220V/230V/240V |         | 1    |          | 408306001 | Screw 3.18 x 6 for Heat sinker (115V)            |         | 4    |
|           | 410849002 | Lower side plate R, assembly for 115V (UL, CSA) |         | 1    | o 46-47  |           | Accessory box assembly                           |         | 1    |
|           | 414578001 | Lower side plate R, assembly for NEW ZEALAND    |         | 1    | o 48     | 413942001 | Filter   |         | 1    |
| 11        | 410519003 | Lower side plate, R for 220V/230V/240V          |         | 1    | 50       | 409700001 | Square nut                                       |         | 2    |
|           | 410876002 | Lower side plate, R for 115V (UL, CSA)          |         | 1    | 51       | 060660406 | Screw 3.18 - 40 x 4                              |         | 2    |
| 12        | 412033001 | AC inlet  |         | 1    | o 52     | 413941001 | Connector cover                                  |         | 1    |
|           | 410816001 | AC inlet for NEW ZEALAND                        |         | 1    | o 53     | 413985001 | Battery  |         | 1    |
| 13        | 410306000 | AC inlet clamp                                  |         | 1    | 54       | 407261001 | Table clamp setting plate                        |         | 2    |
| 14        | 060301004 | + Screw 3 x 10                                  |         | 2    | 55       | 060660704 | Screw 3.18 - 40 x 7                              |         | 4    |
| 15        | 410410000 | Instruction sleeve 4 x 15                       |         | 1    | 56       | 407119001 | Screw 4.37                                       |         | 4    |
| 16        | 410817001 | Filter board assembly for 220V/230V/240V        |         | 1    | 57       | 060660704 | Screw 3.18 - 40 x 7                              |         | 2    |
|           | 410851001 | Filter board assembly for 115V (UL, CSA)        |         | 1    | 58       | 037300816 | Screw 3 x 8                                      |         | 2    |
| 17        | 410828001 | Tubular fuse 1A for 220V/230V/240V              |         | 1    | 59       | 410891001 | Presser for cord clamp                           |         | 1    |
|           | 411433001 | Tubular fuse 1A for 115V (UL, CSA)              |         | 1    | 60       | 410830000 | Insulation board                                 |         | 1    |
| 18        | 060670606 | Screw 3.57 - 40 x 6                             |         | 4    | 61       | 410829000 | Insulation spacer                                |         | 4    |
| 19a       | 409699003 | Lower side plate, L                             |         | 1    | 62       | 025660336 | Washer 3.18                                      |         | 4    |
| 19b       | 414005001 | Yarn tention support base                       |         | 1    | 63       | 028350246 | Spring washer                                    |         | 4    |
| 19c       | 037281216 | Screw 2.6 x 12                                  |         | 4    | 64       | 021660206 | Nut  |         | 4    |
| 20        | 408194003 | Plastic rivet                                   |         | 6    | 65       | 410895001 | AC inlet cord                                    |         | 1    |
| 21        | 404022002 | Carrying case lock assembly                     |         | 2    | 66       | 410892001 | Power switch WK2A5 assembly for 220V/230V/240V   |         | 1    |
| 22        | 404027001 | Carrying case lock spring                       |         | 2    | 100      | 410831001 | Power cord (220V)                                |         | 1    |
| 23        | 403542001 | Fastening plate                                 |         | 2    | 101      | 410832001 | Power cord (115V) for UL & TAIWAN                |         | 1    |
| 24        | 405658001 | Fastening screw 3.18                            |         | 2    |          | 411430001 | Power cord (115V) for CSA                        |         | 1    |
| 25        | 062660504 | Fastening screw 3.18 - 40 x 5                   |         | 2    | 102      | 410833001 | Power cord (240V)                                |         | 1    |
| 26        | 407265000 | Needle bed fastening plate                      |         | 1    | 103      | 410834001 | Power cord (240V)                                |         | 1    |
| 27        | 409640001 | Extention rail lock spring, R                   |         | 1    |          | 414581001 | Power cord (230V) for NEW ZEALAND                |         | 1    |
| 28        | 409639001 | Extention rail lock spring, L                   |         | 1    | 104      | 410854001 | Power cord (220V)                                |         | 1    |
| 29        | 410818000 | Heat sinker plate for 220V/230V/240V            |         | 1    |          |           |  |         |      |
|           | 410517000 | Heat sinker plate for 115V                      |         | 1    |          |           |  |         |      |
| 30        | 413961001 | Power transformer for 220V                      |         | 1    |          |           |  |         |      |
|           | 414580001 | Power transformer for 230V                      |         | 1    |          |           |  |         |      |
|           | 414478001 | Power transformer for 115V                      |         | 1    |          |           |  |         |      |
| 31        | 410400001 | Primary cord for 115V                           |         | 1    |          |           |  |         |      |
| 32        | 410410000 | Insulation sleeve 4 x 15 for 115V               |         | 1    |          |           |  |         |      |
| 33        | 410309001 | Power switch-1801 for 115V                      |         | 1    |          |           |  |         |      |
| 34        | 413936301 | Operation P.C. board assembly                   |         | 1    |          |           |  |         |      |



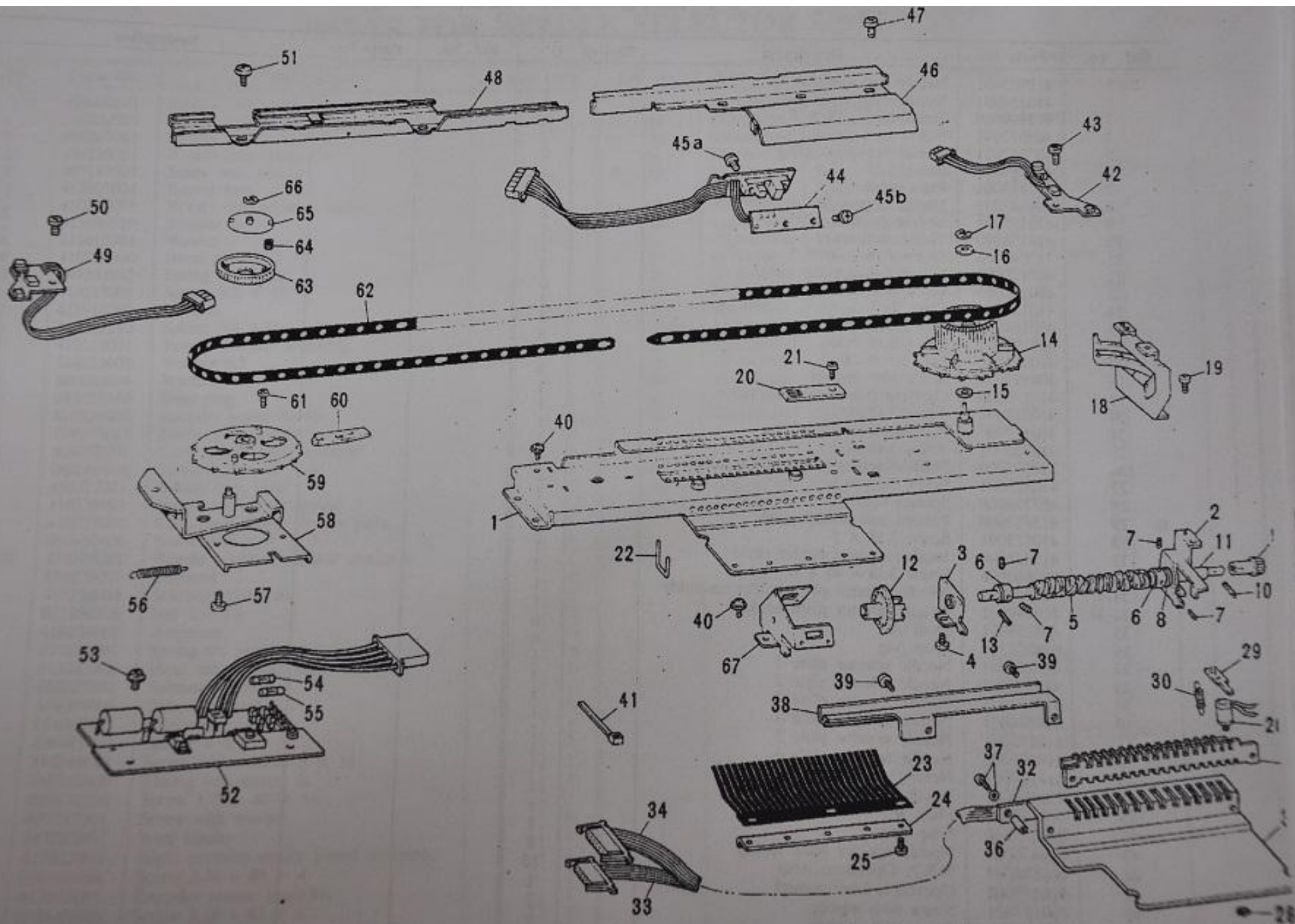

PARTS FOR NEEDLE SELECTOR UNIT Fig

| Ref. No. | Parts No. | Description                          | Revised | Q'ty | Ref. No. | Parts No. | Description                                    | Revised | Q'ty |
|----------|-----------|--------------------------------------|---------|------|----------|-----------|--|---------|------|
| C-1-39   | 413906001 | Rotary cam holder body assembly      |         | 1    | C-48     | 410176001 | Timing belt cover, L                           |         | 1    |
| 1        | 410202001 | Rotary cam holder body               |         | 1    | ○ 49     | 413928001 | Left position sensor board assembly            |         | 1    |
| 2        | 410207001 | Rotary cam holder, R                 |         | 1    | ○ 50     | 060660406 | Screw 3.18 - 40 x 4                            |         | 1    |
| 3        | 410210001 | Rotary cam holder, L                 |         | 1    | ○ 51     | 060660406 | Screw 3.18 - 40 x 4                            |         | 2    |
| 4        | 409197001 | Screw with washer                    |         | 1    | ○ 52     | 413920001 | Power supply board assembly for 220V/230V/240V |         | 1    |
| 5        | 413907001 | Rotary cam                           |         | 1    |          | 414472001 | Power supply board assembly for 115V           |         | 1    |
| 6        | 410215001 | Rotary cam adjuster collar           |         | 2    | 53       | 409197001 | Screw 3.18 x 4                                 |         | 2    |
| 7        | 013680516 | Stopper screw                        |         | 4    | 54       | 410475001 | Tubular fuse 2A for 220V/230V/240V             |         | 1    |
| 8        | 411013001 | Washer                               |         | 1    |          | U15083000 | Tubular fuse 2A for 115V                       |         | 1    |
| 9        | 410216000 | Bevel gear Z12                       |         | 1    | ○ 55     | 413943001 | Tubular fuse 5A for 220V/230V/240V             |         | 1    |
| 10       | 047201042 | Spring pin AW2                       |         | 1    | 55       | U15100000 | Tubular fuse 5A for 115V                       |         | 1    |
| 11       | 410217001 | Spacer 6.2 x 19                      |         | 1    | 56       | 410016001 | Belt tension control spring                    |         | 1    |
| 12       | 413910001 | Slit disc                            |         | 1    | 57       | 406397001 | Screw 3.18 x 5                                 |         | 2    |
| 13       | 047201242 | Spring pin AW2                       |         | 1    | 58-66    | 410181002 | Pulley assembly                                |         | 1    |
| 14       | 410219001 | Rotary encoder assembly              |         | 1    | 58       | 410180001 | Pulley holder plate                            |         | 1    |
| 15       | 410223001 | Washer 6.3                           |         | 1    | 59       | 410182002 | Pulley   |         | 1    |
| 16       | 400806004 | Washer                               |         | 1    | 60       | 412034000 | Pulley adjusting plate                         |         | 1    |
| 17       | 048025346 | Snap ring                            |         | 1    | 61       | 409197001 | Screw 3.18 x 4                                 |         | 2    |
| 18       | 410224000 | Encoder board holder                 |         | 1    | 62       | 410186001 | Timing belt                                    |         | 1    |
| 19       | 409197001 | Screw with washer                    |         | 2    | 63       | 410477001 | Friction plate                                 |         | 1    |
| 20       | 408068001 | Card reader guide stopper            |         | 1    | 64       | 410479001 | Friction plate spring                          |         | 4    |
| 21       | 060660406 | Screw 3.18 - 40 x 4                  |         | 1    | 65       | 410478000 | Presser for friction plate spring              |         | 1    |
| 22       | 410225001 | Rotary cam lever                     |         | 16   | 66       | 048030346 | Snap ring                                      |         | 1    |
| 23       | 410226001 | Rotary cam lever spring              |         | 1    | 67       | 413909000 | Encoder board holder plate                     |         | 1    |
| 24       | 410227001 | Cam lever spring presser plate       |         | 1    |          |           |  |         |      |
| 25       | 060660406 | Screw 3.18 - 40 x 4                  |         | 5    |          |           |  |         |      |
| 26-37    | 414004001 | Needle selector solenoid assembly    |         | 1    |          |           |  |         |      |
| 26       | 410229001 | Solenoid                             |         | 16   |          |           |  |         |      |
| 27       | 410238001 | Solenoid Yoke 16                     |         | 1    |          |           |  |         |      |
| 28       | 021260206 | Nut 2 - 2.6                          |         | 16   |          |           |  |         |      |
| 29       | 410239001 | Armature                             |         | 16   |          |           |  |         |      |
| 30       | 410240001 | Spring for armature                  |         | 16   |          |           |  |         |      |
| 31       | 410241000 | Heat Sink plate for solenoid         |         | 1    |          |           |  |         |      |
| 32       | 410327001 | Solenoid board                       |         | 1    |          |           |  |         |      |
| 33       | 414006001 | Solenoid cord 1                      |         | 1    |          |           |  |         |      |
| 34       | 414007001 | Solenoid cord 2                      |         | 1    |          |           |  |         |      |
| 36       | 408481002 | Spacer 4 x 7                         |         | 2    |          |           |  |         |      |
| 37       | 410249001 | Screw with washer 3 x 14             |         | 2    |          |           |  |         |      |
| 38       | 410243000 | Timing belt cover, R                 |         | 1    |          |           |  |         |      |
| 39       | 060670506 | Screw 3.75 - 40 x 5                  |         | 2    |          |           |  |         |      |
| 40       | 409197001 | Screw with washer                    |         | 6    |          |           |  |         |      |
| 41       | 547262001 | Wire binder                          |         | 1    |          |           |  |         |      |
| 42       | 413925001 | Right position sensor board assembly |         | 1    |          |           |  |         |      |
| 43       | 060660406 | Screw 3.18 - 40 x 4                  |         | 1    |          |           |  |         |      |
| 44       | 413912001 | Encoder sensor assembly              |         | 1    |          |           |  |         |      |
| 45a      | 062660806 | Screw 3.18 - 40 x 8                  |         | 2    |          |           |  |         |      |
| 45b      | 062660506 | Screw 3.18 - 40 x 5                  |         | 2    |          |           |  |         |      |
| 46       | 413911000 | Cored cover                          |         | 1    |          |           |  |         |      |
| 47       | 060630416 | Screw 2.38 - 56 x 4                  |         | 3    |          |           |  |         |      |



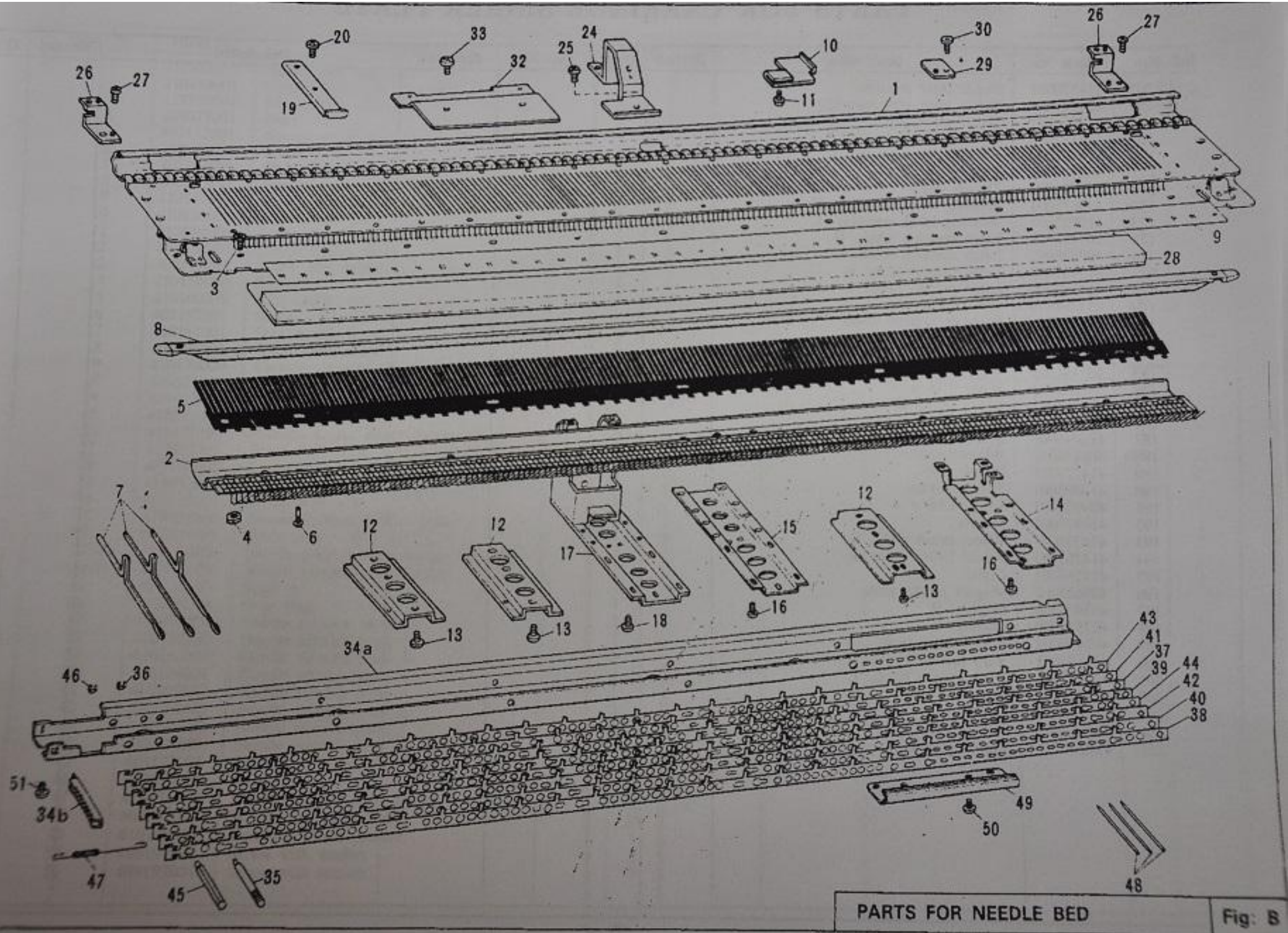

PARTS FOR NEEDLE BED

Fig. 8



| Ref. No. | Parts No. | Description                           | Revised | Q'ty | Ref. No. | Parts No. | Description |
|----------|-----------|---------------------------------------|---------|------|----------|-----------|-------------|
| B- 1     | 412803001 | Needle bed assembly                   |         | 1    |          |           |             |
| 2        | 410154001 | Needle bed comb assembly              |         | 1    |          |           |             |
| 3        | 412109004 | Screw 2.38 - 56 x 7                   |         | 12   |          |           |             |
| 4        | 405077001 | Nut                                   |         | 12   |          |           |             |
| 5        | 407112001 | Needle retaining spring               |         | 1    |          |           |             |
| 6        | 407687001 | Screw 3.18                            |         | 3    |          |           |             |
| 7        | 407113001 | Plain needle                          |         | 200  |          |           |             |
| 8        | 409643001 | Needle presser bar assembly           |         | 1    |          |           |             |
| 9        | 410157001 | Needle position indicator             |         | 1    |          |           |             |
| 10       | 410156000 | Timing belt cover                     |         | 1    |          |           |             |
| 11       | 412048006 | Screw 3.18 - 40 x 3                   |         | 1    |          |           |             |
| 12       | 407120000 | Lower holder plate                    |         | 3    |          |           |             |
| 13       | 409197001 | Screw with washer                     |         | 6    |          |           |             |
| 14       | 410159000 | Stay, R                               |         | 1    |          |           |             |
| 15       | 410160000 | Stay centre, A                        |         | 1    |          |           |             |
| 16       | 409197001 | Screw 3.18 x 4                        |         | 8    |          |           |             |
| 17       | 410161001 | Stay centre, B                        |         | 1    |          |           |             |
| 18       | 409197001 | Screw with washer                     |         | 4    |          |           |             |
| 19       | 410170000 | Carrying case reinforcing plate       |         | 1    |          |           |             |
| 20       | 410523001 | Screw 3.18 x 5                        |         | 1    |          |           |             |
| 24       | 410177000 | Pattern case setting base             |         | 1    |          |           |             |
| 25       | 410523001 | Screw 3.18 x 5                        |         | 1    |          |           |             |
| 26       | 410175000 | Position sensor board holder plate    |         | 2    |          |           |             |
| 27       | 410523001 | Screw 3.18 x 5                        |         | 2    |          |           |             |
| 28       | 407703000 | Sponge bar                            |         | 1    |          |           |             |
| o 29     | 413952000 | Pattern case holder plate             |         | 1    |          |           |             |
| 30       | 410523001 | Screw 3.18 x 5                        |         | 1    |          |           |             |
| o 32     | 413924000 | Insulation sheet holder plate         |         | 1    |          |           |             |
| 33       | 060660606 | Screw 3.18 - 40 x 6                   |         | 2    |          |           |             |
| 34-47    | 410188001 | Needle selector plate holder assembly |         | 1    |          |           |             |
| 34-36    | 410189001 | Needle selector plate holder          |         | 1    |          |           |             |
| 35       | 408159001 | Shaft A                               |         | 6    |          |           |             |
| 36       | 048025346 | Snap ring                             |         | 6    |          |           |             |
| 37       | 410191001 | Needle selector plate 1               |         | 1    |          |           |             |
| 38       | 410192001 | Needle selector plate 2               |         | 1    |          |           |             |
| 39       | 410193001 | Needle selector plate 3               |         | 1    |          |           |             |
| 40       | 410194001 | Needle selector plate 4               |         | 1    |          |           |             |
| 41       | 410195001 | Needle selector plate 5               |         | 1    |          |           |             |
| 42       | 410196001 | Needle selector plate 6               |         | 1    |          |           |             |
| 43       | 410197001 | Needle selector plate 7               |         | 1    |          |           |             |
| 44       | 410198001 | Needle selector plate 8               |         | 1    |          |           |             |
| 45       | 408172001 | Shaft B                               |         | 1    |          |           |             |
| 46       | 048025346 | Snap ring                             |         | 1    |          |           |             |
| 47       | 410476001 | Needle selector plate spring          |         | 8    |          |           |             |
| 48       | 408098001 | N.S.P. Operation lever                |         | 16   |          |           |             |
| 49       | 410199001 | Operation lever presser               |         | 1    |          |           |             |
| 50       | 409197001 | Screw with washer                     |         | 2    |          |           |             |
| 51       | 409197001 | Screw with washer                     |         | 9    |          |           |             |



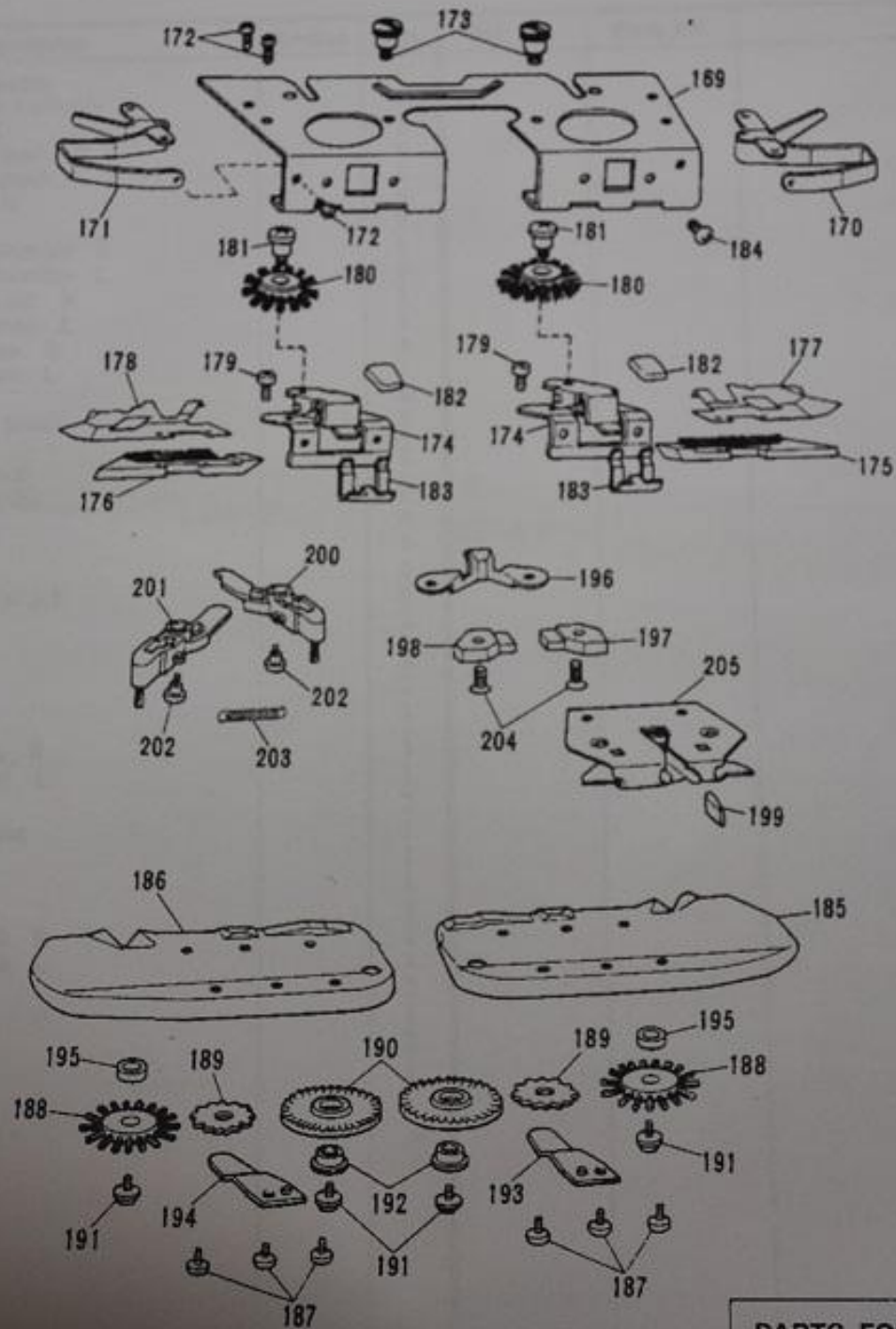

PARTS FOR CARRIAGE SINKER PLATE

Fig: A

# PARTS FOR CARRIAGE SINKER PLATE

| Ref. No.   | Parts No. | Description               | Revised | Q'ty | Ref. No. | Parts No. | Description | Revised |
|------------|-----------|---------------------------|---------|------|----------|-----------|-------------|---------|
| II-169-205 | 414120001 | Sinker plate assembly     |         | 1    |          |           |             |         |
| 169-195    | 414121001 | Sinker plate arm assembly |         | 1    |          |           |             |         |
| 169        | 414416001 | Sinker plate arm          |         | 1    |          |           |             |         |
| 170        | 414122000 | Weaving thread guide, R   |         | 1    |          |           |             |         |
| 171        | 414123000 | Weaving thread guide, L   |         | 1    |          |           |             |         |
| 172        | 409162001 | Tapping screw 2.6         |         | 6    |          |           |             |         |
| 173        | 409626001 | Thumb screw               |         | 2    |          |           |             |         |
| 174a       | 410026001 | Weaving lever assembly, R |         | 1    |          |           |             |         |
| 174b       | 410027001 | Weaving lever assembly, L |         | 1    |          |           |             |         |
| 175        | 407435002 | Latch opening brush, R    |         | 1    |          |           |             |         |
| 176        | 407436002 | Latch opening brush, L    |         | 1    |          |           |             |         |
| 177        | 414191000 | Latch presser plate, R    |         | 1    |          |           |             |         |
| 178        | 414192000 | Latch presser plate, L    |         | 1    |          |           |             |         |
| 179        | 037286616 | Screw 2.6 x 6             |         | 4    |          |           |             |         |
| 180        | 414417001 | Weaving pattern brush     |         | 2    |          |           |             |         |
| 181        | 408316001 | Screw 3.18                |         | 2    |          |           |             |         |
| 182        | 409629003 | Weaving lever knob        |         | 2    |          |           |             |         |
| 183        | 407441001 | Weaving lever spring      |         | 2    |          |           |             |         |
| 184        | 408305001 | Screw 3.18 x 5            |         | 4    |          |           |             |         |
| 185        | 414253001 | Sinker plate, R           |         | 1    |          |           |             |         |
| 186        | 414257001 | Sinker plate, L           |         | 1    |          |           |             |         |
| 187        | 412049006 | Screw 3.18 - 40 x 3.5     |         | 6    |          |           |             |         |
| 188        | 408146002 | Wheel brush               |         | 2    |          |           |             |         |
| 189        | 414259001 | Plastic gear              |         | 2    |          |           |             |         |
| 190        | 413403001 | Rubber wheel              |         | 2    |          |           |             |         |
| 191        | 409621001 | Screw 3.18 x 4            |         | 2    |          |           |             |         |
| 192        | 410970001 | Holder                    |         | 2    |          |           |             |         |
| 193        | 414261001 | Wheel brush plate, R      |         | 1    |          |           |             |         |
| 194        | 414262001 | Wheel brush plate, L      |         | 1    |          |           |             |         |
| 195        | 414260001 | Collar                    |         | 2    |          |           |             |         |
| 196        | 409625000 | Magnet holder plate       |         | 1    |          |           |             |         |
| 197        | 407454000 | Magnet, R                 |         | 1    |          |           |             |         |
| 198        | 407578000 | Magnet, L                 |         | 1    |          |           |             |         |
| 199        | 407450004 | Yarn feeder knob          |         | 1    |          |           |             |         |
| 200        | 414196001 | Yarn presser brush, R     |         | 1    |          |           |             |         |
| 201        | 414197001 | Yarn presser brush, L     |         | 1    |          |           |             |         |
| 202        | 414249001 | Screw                     |         | 2    |          |           |             |         |
| 203        | 414250001 | Spring                    |         | 1    |          |           |             |         |
| 204        | 413247001 | Screw 2.38 x 10           |         | 2    |          |           |             |         |
| 205        | 414130001 | Yarn feeder body          |         | 1    |          |           |             |         |